

 **3+**
 **22**
 **1,37m**









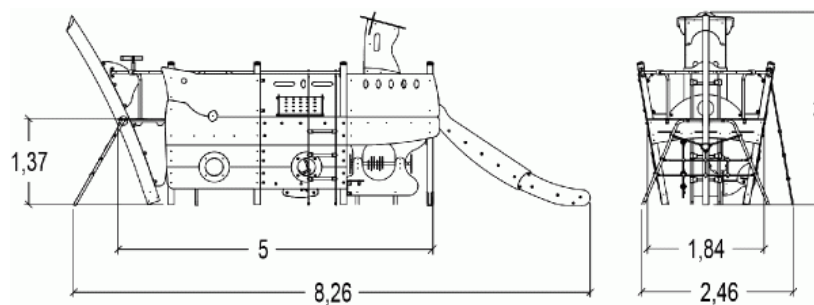
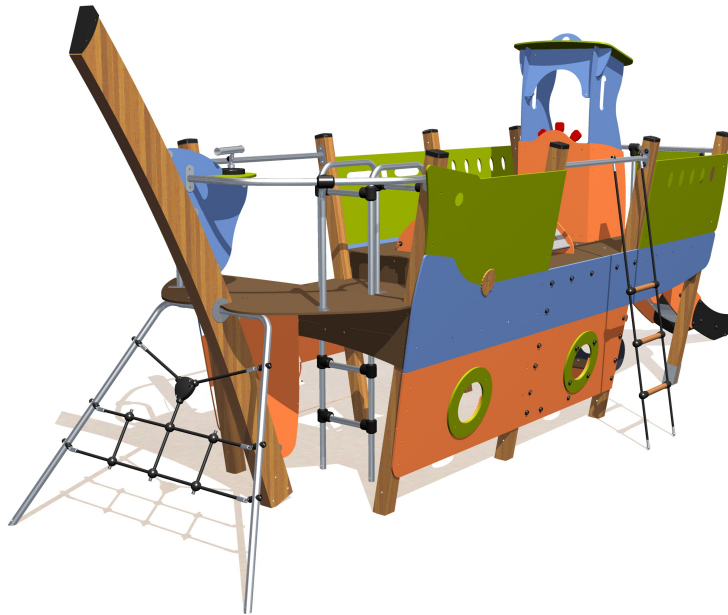





Physical inclusion
Sensory inclusion
Cognitive inclusion



Play value :

31

role play	sliding	meeting	resting	handling	hiding	taking shelter	thinking
							
x3	x1	x3	x2	x4	x3	x2	x1
tactile stimulation	visual stimulation	climbing	getting across				
							
x4	x3	x3	x2				

Components

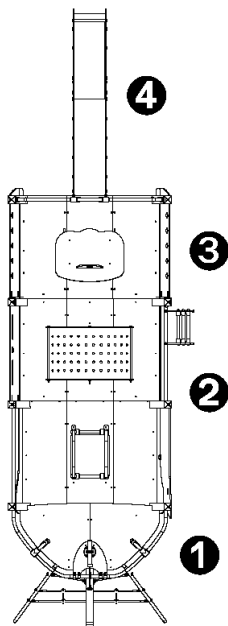

- ① THE STERN
- ② THE NARROW BOAT
- ③ THE BOW
- ④ STAINLESS STEEL INOX

Installation of equipment

IMPORTANT: It is essential to refer to the installation instructions for information on the size of the safety areas.

-  Impact area (minimum normative surface)
-  Free space

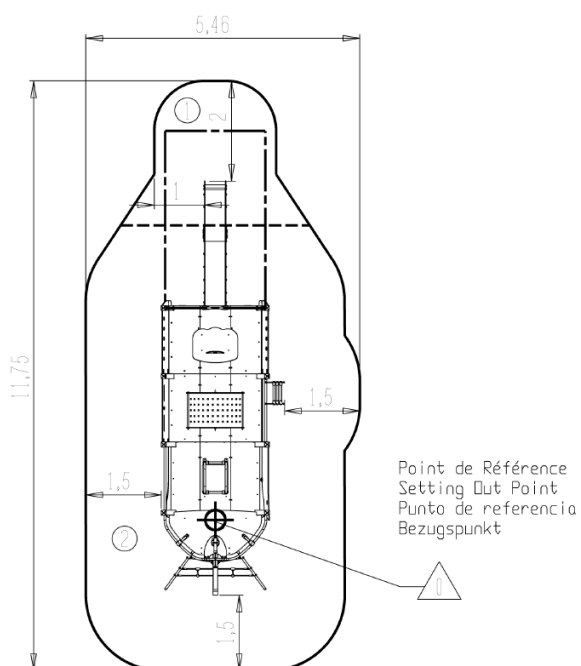

1	1m	7,5m ²
2	1,37m	45m ²



2



40h00



0.6m³



52.5m²



988kg



33kg

EN

1176