



2+



4



0,75m



1 = 2,26m
2 = 0,29m
3 = 0,72m



Physical inclusion
Sensory inclusion
Cognitive inclusion

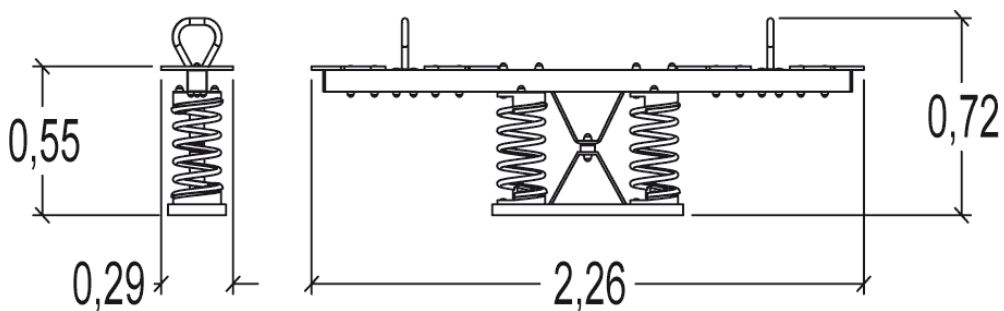
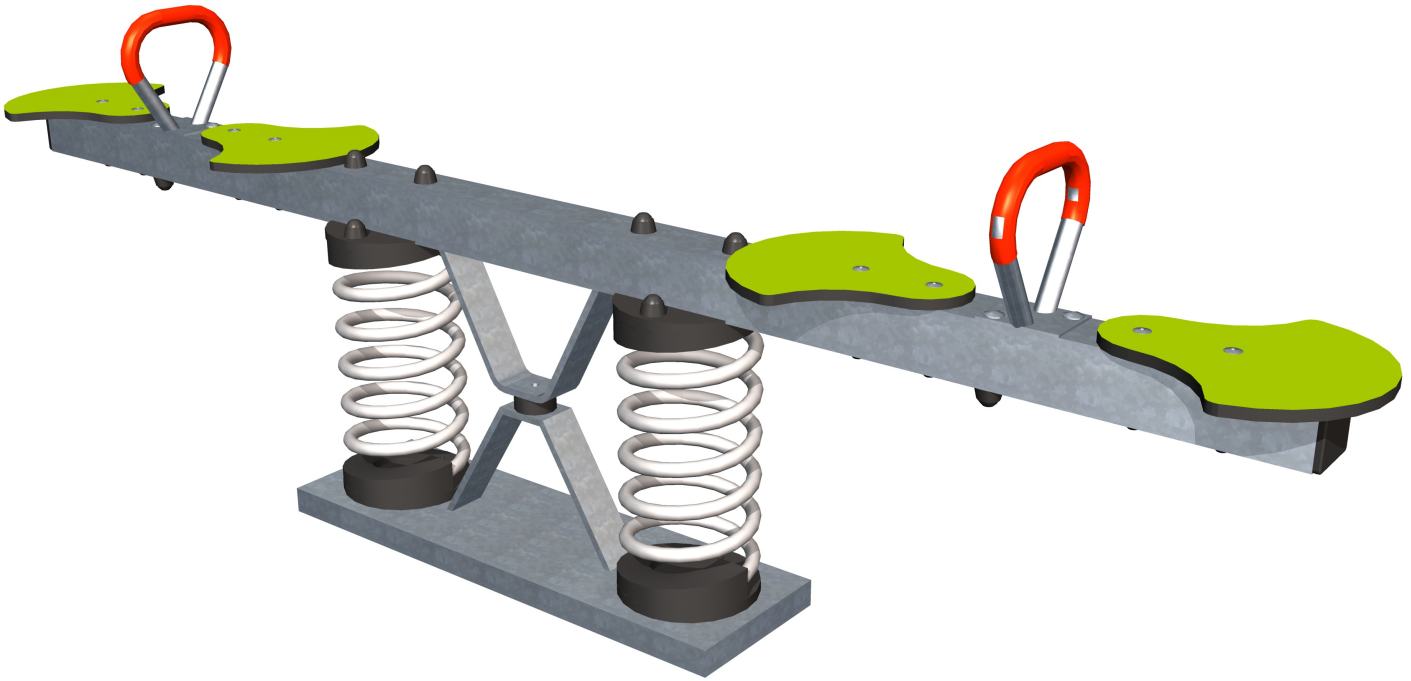

Play value : **4**

role play



x1

meeting



x1

balancing



x1



Oscillate





x1

Installation of equipment

IMPORTANT: It is essential to refer to the installation instructions for information on the size of the safety areas.

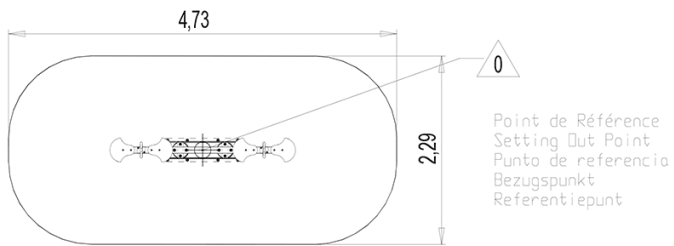
-  Impact area (minimum normative surface)
-  Free space



		
1	0,75m	10m ²



2



0m³



10m²



64kg



44kg

