

 **2+**
 **2**
 **0m**



 1 = 0,2m
 2 = 0,5m
 3 = 1,15m



Physical inclusion
Sensory inclusion
Cognitive inclusion

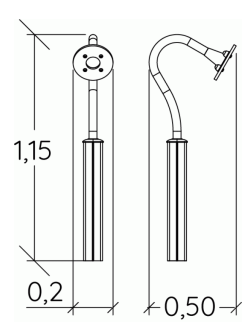

Play value : **2**

meeting

x1

sound stimulation

x1

Installation of equipment

IMPORTANT: It is essential to refer to the installation instructions for information on the size of the safety areas.

———— Impact area (minimum normative surface)

- - - - Free space

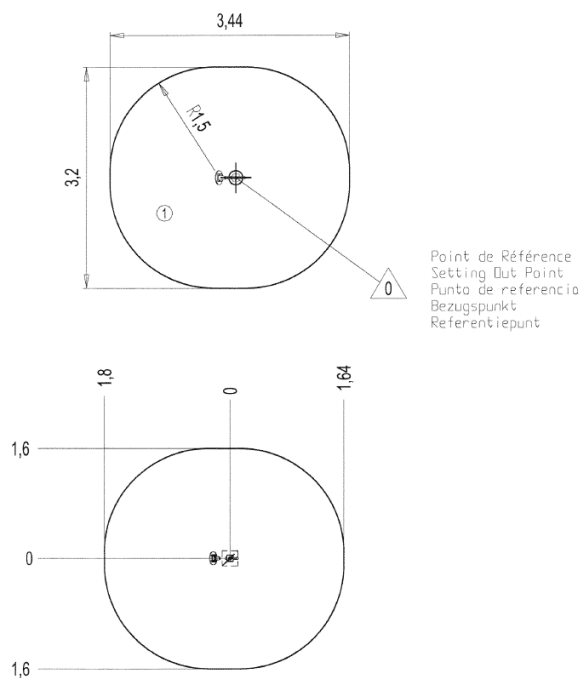

1	0m	18m ²



2



01h00



0.1m³



18m²



33kg



6kg

