



2+



25



1,37m



1 = 9,2m
2 = 6,72m
3 = 3,22m



Physical inclusion
Sensory inclusion
Cognitive inclusion

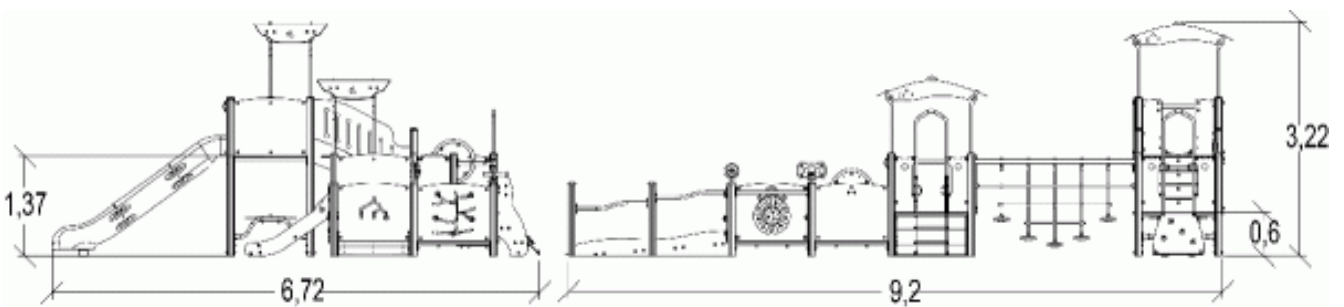

Play value : **71**

climbing



x1

role play



x11

sliding



x2

meeting



x9

resting



x2

handling



x13

balancing



x1

taking shelter



x2

thinking



x7

tactile stimulation



x13

visual stimulation



x4

climbing



x4

getting across



x2

Components

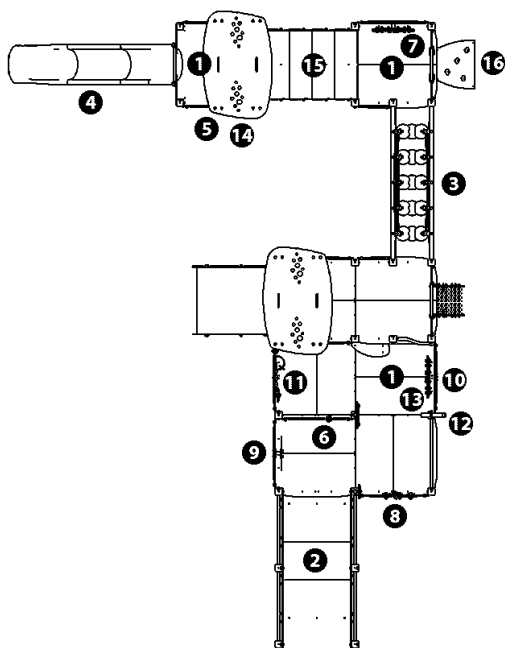

- ❶ Square platform
- ❷ Access ramp
- ❸ Floating steps
- ❹ Polyethylene slide H: 1.37m
- ❺ Play table
- ❻ 'Maze' board
- ❼ Pinball panel
- ❽ Flower panel
- ❾ Lottery Panel
- ❿ The Pachinko Play Panel
- ⓫ Triple play panel
- ⓬ Telescope
- ⓭ Coloured binoculars
- ⓮ Spinning disc
- ⓯ Steps
- ⓰ Slope

Installation of equipment

IMPORTANT: It is essential to refer to the installation instructions for information on the size of the safety areas.

- Impact area (minimum normative surface)
- Free space

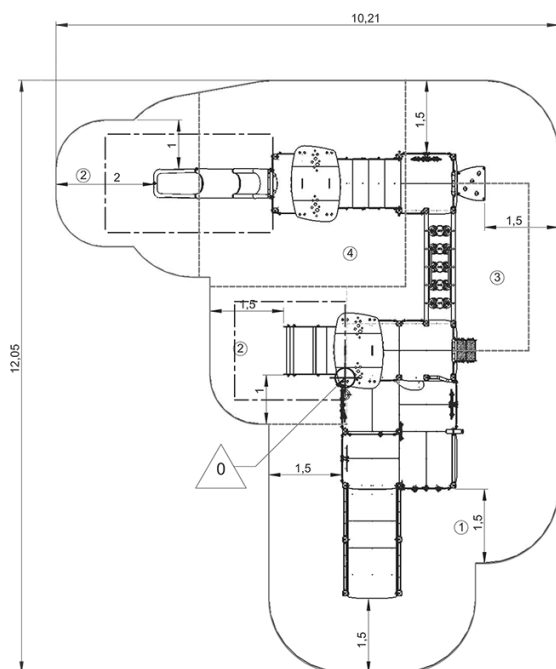

1	0,6m	41m ²
2	1m	16m ²
3	1,3m	8,5m ²
4	1,37m	17,5m ²



3



55h00



0.96m³



83m²



1362kg



29kg

EN

1176