



5 59 850 011 00

## minimondo play unit Concrete Mixer







made in germany

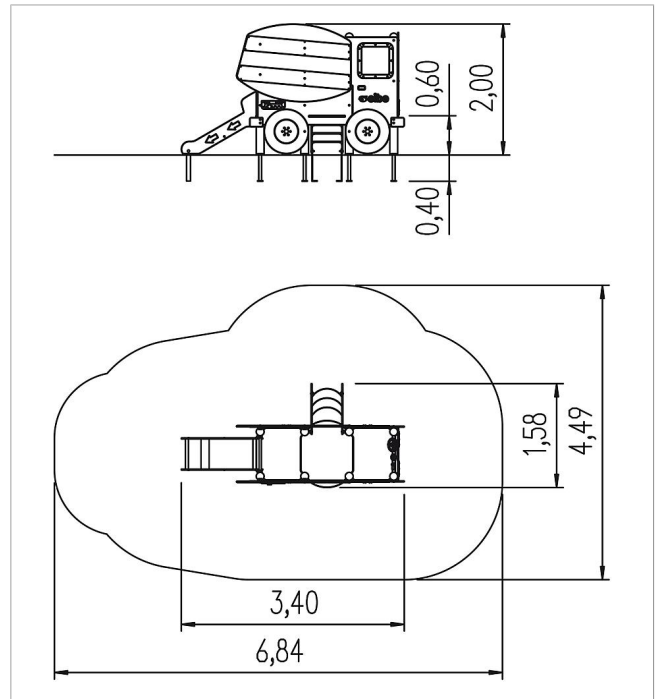

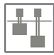
### Scope of delivery

- 1x slide: HPL, stainless steel
- 1x stair: HPL
- 3x platform surface: HPL
- 2x panel with window: HPL, Makrolon
- 1x panel with lights: HPL, Plexiglas
- 1x playing panel mirror: HPL, Plexiglas
- 1x playing panel control console: SW, HPL
- 1x playing panel lever: HPL, stainless steel
- 1x set posts with post bases: SW, galvanised steel



|   |                       |                          |
|---|-----------------------|--------------------------|
|  | Material              | SW pi                    |
|  | Foundation level      | ET 400                   |
|  | Minimum space         | 6,84x4,49x2,40 m         |
|  | Free falling height   | 60 cm                    |
|  | Impact protection net | 7,5 m <sup>2</sup>       |
|  | Foundations           | 3x CF or 2x PFs + 8x PFr |
|  | Assembly              | 2 persons/4 h            |
|  | Largest section       | Ø 12x226 cm              |
|  | Heaviest section      | 55 kg                    |